

U.S. Drought Monitor

Kickapoo (KS) Reservation

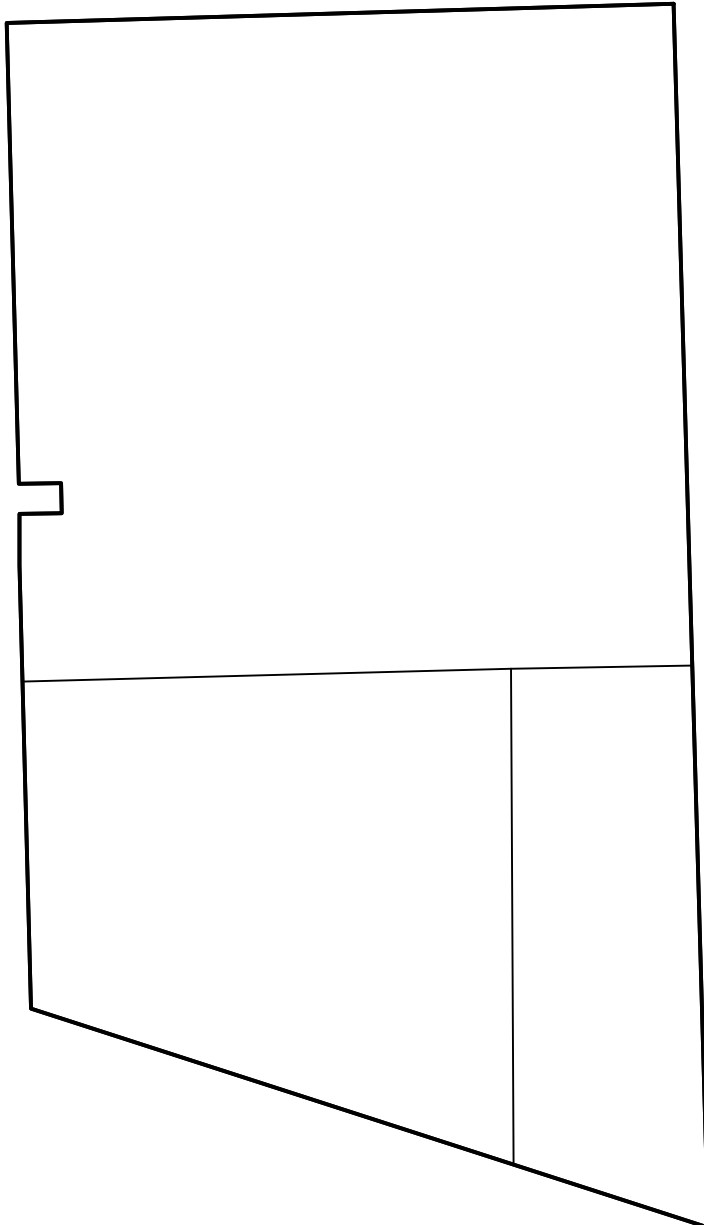

August 3, 2021
 (Released Thursday, Aug. 5, 2021)
 Valid 8 a.m. EDT

Drought Conditions (Percent Area)

	None	D0-D4	D1-D4	D2-D4	D3-D4	D4
Current	100.00	0.00	0.00	0.00	0.00	0.00
Last Week <i>07-27-2021</i>	100.00	0.00	0.00	0.00	0.00	0.00
3 Months Ago <i>05-04-2021</i>	3.66	96.34	0.00	0.00	0.00	0.00
Start of Calendar Year <i>12-29-2020</i>	0.00	100.00	100.00	0.00	0.00	0.00
Start of Water Year <i>09-29-2020</i>	18.21	81.79	0.00	0.00	0.00	0.00
One Year Ago <i>08-04-2020</i>	100.00	0.00	0.00	0.00	0.00	0.00

Intensity:

- None
- D0 Abnormally Dry
- D1 Moderate Drought
- D2 Severe Drought
- D3 Extreme Drought
- D4 Exceptional Drought

The Drought Monitor focuses on broad-scale conditions. Local conditions may vary. For more information on the Drought Monitor, go to <https://droughtmonitor.unl.edu/About.aspx>

Author:

Richard Tinker
 CPC/NOAA/NWS/NCEP

