

U.S. Drought Monitor Onondaga Nation Reservation

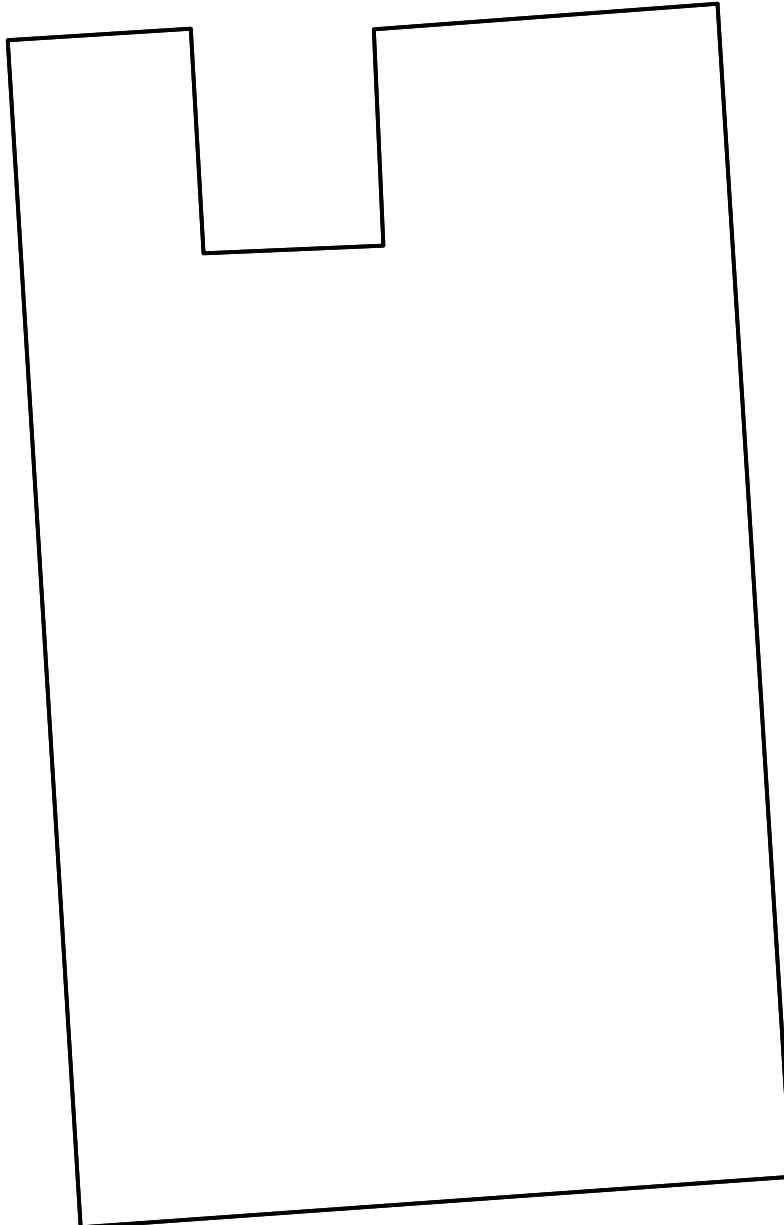

October 19, 2021
(Released Thursday, Oct. 21, 2021)
Valid 8 a.m. EDT

Drought Conditions (Percent Area)

| | None | D0 | D1 | D2 | D3 | D4 |
|--|--------|--------|--------|------|------|------|
| Current | 100.00 | 0.00 | 0.00 | 0.00 | 0.00 | 0.00 |
| Last Week <i>10-12-2021</i> | 100.00 | 0.00 | 0.00 | 0.00 | 0.00 | 0.00 |
| 3 Months Ago <i>07-20-2021</i> | 100.00 | 0.00 | 0.00 | 0.00 | 0.00 | 0.00 |
| Start of Calendar Year <i>12-29-2020</i> | 0.00 | 100.00 | 0.00 | 0.00 | 0.00 | 0.00 |
| Start of Water Year <i>09-28-2021</i> | 100.00 | 0.00 | 0.00 | 0.00 | 0.00 | 0.00 |
| One Year Ago <i>10-20-2020</i> | 0.00 | 0.00 | 100.00 | 0.00 | 0.00 | 0.00 |

Intensity:

| | |
|---|--|
|  None |  D2 Severe Drought |
|  D0 Abnormally Dry |  D3 Extreme Drought |
|  D1 Moderate Drought |  D4 Exceptional Drought |

The Drought Monitor focuses on broad-scale conditions. Local conditions may vary. For more information on the Drought Monitor, go to <https://droughtmonitor.unl.edu/About.aspx>

Author:

Brad Pugh
CPC/NOAA



droughtmonitor.unl.edu